

R Cartridge Filters

Rugged, low-cost cartridge design for flow rates to 100 gpm*

These cartridge-filter housings are rugged and low in cost. They hold five cartridges, in 10-inch, 20-inch, 30-inch, or 40-inch lengths, using industry standard designs (222, SOE, or DOE). The unique, "quick-opening" clamp design uses a standard O-ring.

Standard Features

- Low pressure drop
- Permanently piped housings are opened without disturbing the piping or requiring tools
- Quick-opening, clamp-type cover
- Carbon or stainless steel housings
- Adjustable-height tripod legs
- Holds 5 cartridge elements
- Accommodates cartridge elements in four lengths: 10", 20", 30", 40"
- 125-psi rated housing
- 3/4-inch clean-dirty/gage ports
- 2-inch female NPT ports
- V posts or threaded-center posts
- Standard hardware V-post and spring seals are 316 stainless steel.
- O-ring seals: Buna N, EPR, Viton®

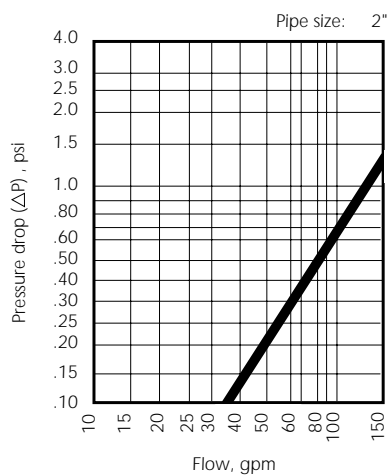

*Based on housing only. Fluid viscosity, filter cartridge used, and expected dirt loading should be considered when sizing a filter.

R How To Order

Reduced Pressure Model 8 Cartridge Housing

Build an ordering code as shown in the example

	Housing	Options
Example:	8520 - 2P - 1 - 125 - S - B - 222	
REDUCED PRESSURE MODEL 8 CARTRIDGE HOUSING = 8		
NUMBER OF CARTRIDGES 5 = 5		
CARTRIDGE LENGTH 10 inch = 10 20 inch = 20 30 inch = 30 40 inch = 40		
PIPE SIZE 2-inch female NPT = 2P		
OUTLET STYLE Bottom = 1		
PRESSURE RATING 125 PSI = 125		
HOUSING MATERIAL Carbon Steel = C 304 Stainless Steel = S		
COVER SEAL Buna N = B Ethylene Propylene = E Viton® Fluorelastomer = V		
CARTRIDGE DESIGN¹ 222 = 222 Single-open End = SOE Double-open End ² = DOE		

1. Filter cartridges are specified separately. See pages 135-143.
2. Comes with V-Posts and spring seals.

Dimensions (IN)

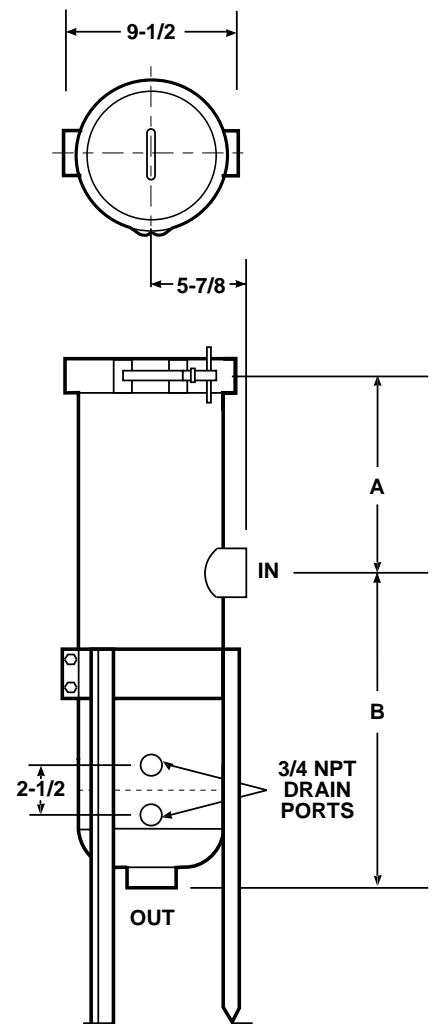

Cart. Length	A	B
10	6	14-13/16
20	11	19-13/16
30	16	24-13/16
40	21	29-13/16